

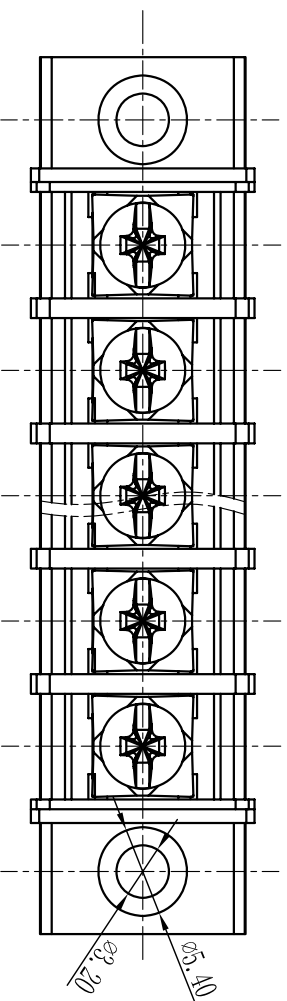

慈溪市万捷电子有限公司

CIXI WANJIE ELECTRONIC CO., LTD

产品规格书
product specification

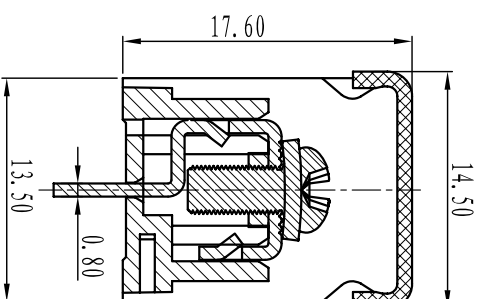
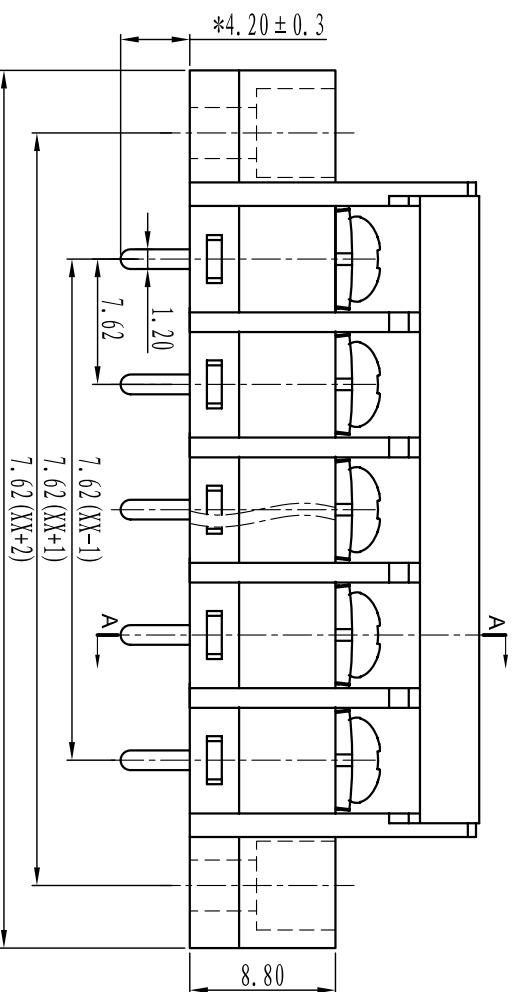

电气性能/Electrical
 参考标准/Standard: UL IEC
 额定电压/Rated voltage: 300V 250V
 额定电流/Rated current: 15A 24A
 使用线径/Wire range: 22-14AWG 2.5mm²
 耐电压/Withstanding voltage: AC2000V/1Min
 绝缘电阻/Insulation resistance: 500M Ω /DC500V

机械性能/Mechanical

温度范围/Temp.Range: -40[°]C~+105[°]C
 最大锁紧力矩/Max.Torque: 0.5Nm (4.5lb.in)

尺寸/Dimensions

间距/Pitch: 7.62mm

极数/Poles: 2P-24P

材质及电镀/Material

塑件/Housing: PA66, UL94V-0

螺丝/Screws: M3.0, steel Ni plated

焊脚/Pin header: Brass, 0.8t, Tin plated

TOLERANCES EXCEPT AS NOTED

	linear dimension	fillet	chamfer	short angle sid	≡	□	//	⊥
variable range	over 6 to 30	over 120 to 480	all to 6	over 10 to 50	over 120 to 120	all to 5	over 5 to 30	over 120 to 120
tolerance	±0.1 to ±0.2	±0.3 to ±0.5	±0.2 to ±0.5	±1 to 1 [°]	30' to 20'	10' to 0.5	0.025 to 0.06	0.12 to 0.4

订购方式：
HOW TO ORDER

型号/Model 极数/POLE P 客户需求/Custom Request

未定义/No definition 蓝色/Blue 绿色/Green 黄色/Yellow

双连/Double pitch 黑色/Black 红色/Red 白色/White

单位/UNITS mm 尺寸/SIZE A4 比例/SCALE 1:4

第一视角/FIRST ANGLE PROJECTION

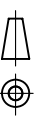

慈溪市万捷电子有限公司
CIXI WANJIE ELECTRONIC CO., LTD

名称/NAME

WJ28CM-XXP-1Y-00A